

joint part 7

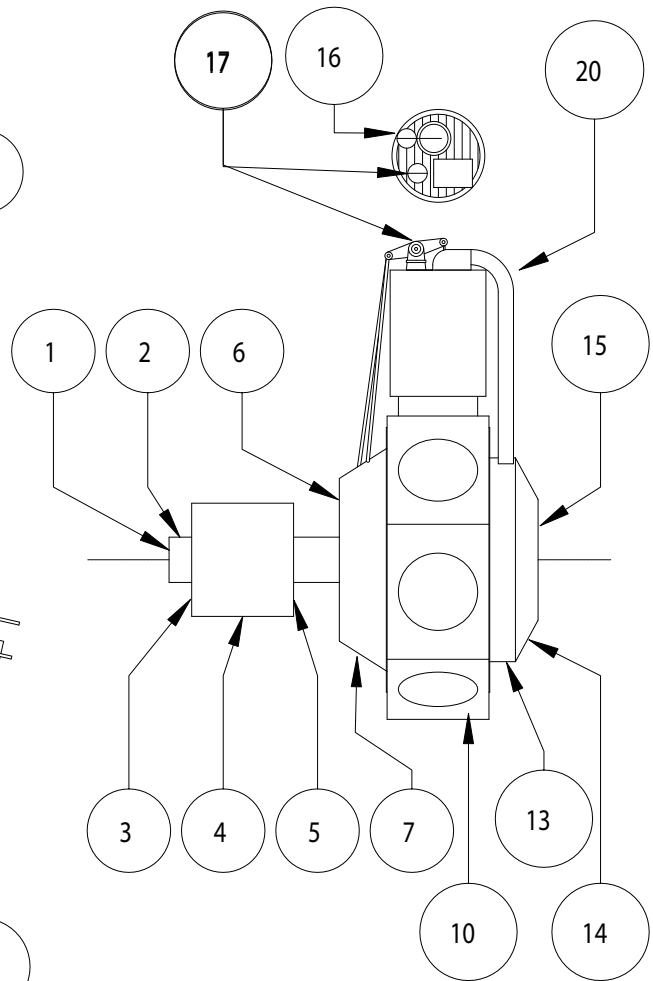

joint parts 13 & 14

Clerget 7Z  
 1913  
 bore 120mm  
 stroke 150mm  
 displacement 11.869cc  
 80hp @1250rpm  
 weight 125kg  
 constructed at Clerget-Blin  
 mounted on airplanes of Clément-Bayard,  
 Deperdussin, Caudron, hydravion Donnet  
 Avro 504, Bristol SCout, RAF BE8,  
 RAF SE2, Sopwith Pup.

(source Gerhard Hartmann)